

STRAIGHT PLUG SOLDER TYPE

R125.055.042

CABLE .141

Series : SMA

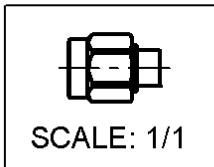
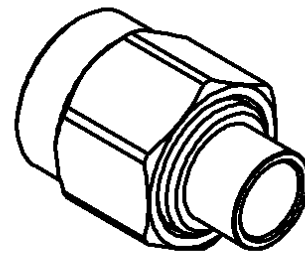
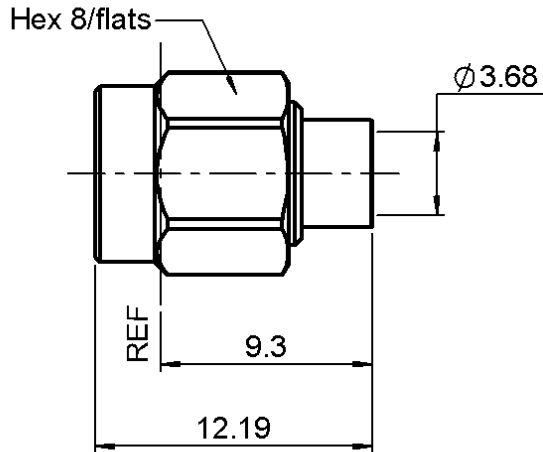

All dimensions are in mm.



COMPONENTS	MATERIALS	PLATINGS (µm)
BODY	STAINLESS STEEL	GOLD 0.8 OVER NICKEL 2
CENTER CONTACT	BRASS	GOLD 1.3 OVER COPPER 0.5
OUTER CONTACT	-	-
INSULATOR	PTFE	-
GASKET	SILICONE RUBBER	-
OTHERS PARTS	STAINLESS STEEL	GOLD 0.5 OVER NICKEL 2
-	-	-
-	-	-

Issue : 0245 A

In the effort to improve our products, we reserve the right to make changes judged to be necessary.



STRAIGHT PLUG SOLDER TYPE

R125.055.042

CABLE .141

Series : SMA

PACKAGING

Standard	Unit	Other
100	'W' option	Contact us

SPECIFICATION

ELECTRICAL CHARACTERISTICS

Impedance		50	Ω
Frequency		0-18	GHz
VSWR	1.05 +	0.008	x F(GHz) Maxi
Insertion loss		0.03	\sqrt{F} (GHz) dB Maxi
RF leakage	- (90	- F(GHz)) dB Maxi
Voltage rating		500	Veff Maxi
Dielectric withstanding voltage		1000	Veff mini
Insulation resistance		5000	M Ω mini

CABLE ASSEMBLY

Stripping	a	b	c	d	e	f
mm	4.20	0.00	0.00	0.00	0.00	0.00

Assembly instruction :

Recommended cable(s)
KS 2
RG 402

Cable retention

- pull off **270** N mini
- torque **NA** N.cm

MECHANICAL CHARACTERISTICS

Center contact retention		
Axial force – Mating end	NA	N mini
Axial force – Opposite end	NA	N mini
Torque	NA	N.cm mini

TOOLING

Part Number	Description	Hexagon
.	.	.

Recommended torque		
Mating	100	N.cm
Panel nut	NA	N.cm
Clamp nut	NA	N.cm
A/F clamp nut	0.000	mm

Mating life	500	Cycles mini
Weight	2.301	g

OTHERS CHARACTERISTICS

-

ENVIRONMENTAL

Operating temperature	-65/+105	$^{\circ}$ C
Hermetic seal	NA	Atm.cm3/s
Panel leakage	NA	

Issue : 0245 A

In the effort to improve our products, we reserve the right to make changes judged to be necessary.



STRAIGHT PLUG SOLDER TYPE

R125.055.042

CABLE .141

Series : SMA

COMPONENTS

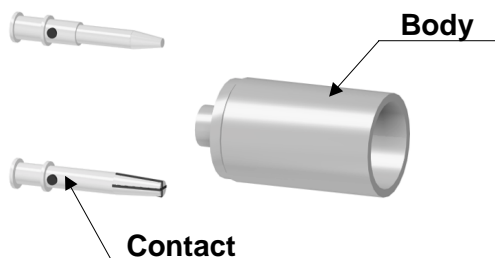

STRIPPING DIMENSIONS



1

Strip the cable.

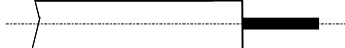

3

Place the connector into the soldering jig.
Slide the cable into the connector until it bottoms against the body.
Tighten.
Put three rings of solder around the cable and solder.
After cooling, remove the assembly from the jig.

2

Mount the positioner, R282.744.220, onto the soldering jig, R282.740.000.
Slide the centre contact into the positioner.
Insert the solder gauge, A731.15.000, between the centre contact and the cable.
Tighten.
Solder the centre contact.
After cooling, remove the assembly from the jig.

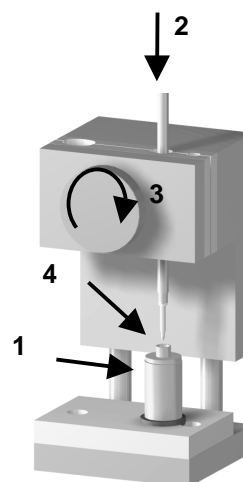

1 - Positioner

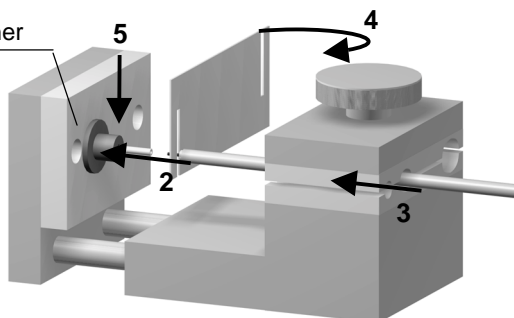

Issue : 0245 A

In the effort to improve our products, we reserve the right to make changes judged to be necessary.

